



INSTRUCTION BULLETIN

No. 340812
Machine: M20/T20
Published: 03-2015
Rev. 01

NOTE: DO NOT DISCARD the Parts List from the Instruction Bulletin. Place the Parts List in the appropriate place in the machine manual for future reference. Retaining the Parts List will make it easier to reorder individual parts and will save the cost of ordering an entire kit.

NOTE: Numbers in parenthesis () are reference numbers for parts listed in Bill of Materials.

Installation instructions for **kit number 9001314**

SYNOPSIS:

This kit contains the parts needed to install an overhead guard on M20/T20 machines.
Please follow step-by-step instructions.

SPECIAL TOOLS / CONSIDERATIONS: NONE

(Estimated time to complete: 1 hour)



PROTECT THE ENVIRONMENT

Please dispose of packaging materials, used machine components such as batteries and fluids in an environmentally safe way according to local waste disposal regulations.

Always remember to recycle.

PREPARATION:

1. Park the machine on a clean level surface, turn off the machine, remove the key, and set the parking brake.

FOR SAFETY: Before leaving or servicing machine, stop on level surface, set parking brake, turn off machine, and remove key.

INSTALLATION:

1. Open the front shroud.
2. Remove the access panel from the operators compartment. Set the access panel and all mounting hardware aside. (Fig. 1)

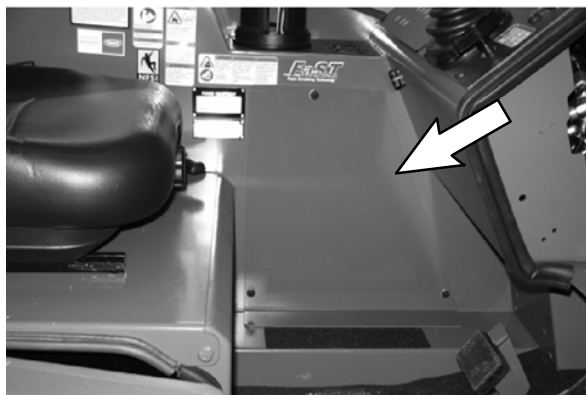

FIG. 1

3. Remove the plastic plug from the control panel located next to the operators seat. Discard the plastic plug. (Fig. 2)

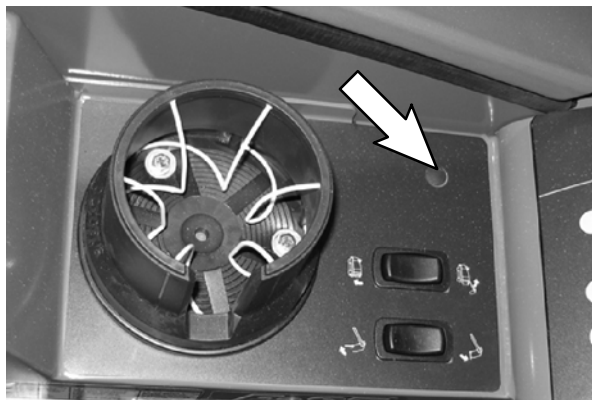

FIG. 2

4. **For machines equipped with spray wand option only:** Remove the spray wand bracket from the machine. Set the spray wand bracket aside. (Fig. 3)

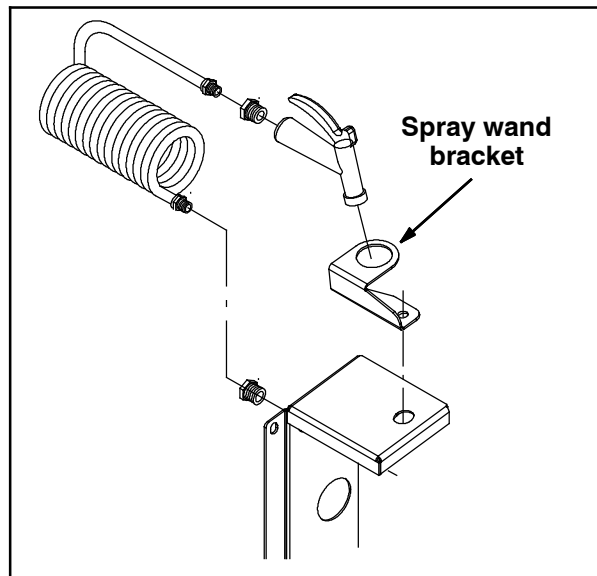

FIG. 3

5. Use two hex screws (4) and two flat washers (12) to install the left overhead guard tube (2) onto the machine. Reinstall the spray wand bracket over the foot on the left overhead guard tube if the bracket was removed in the previous step. Do not completely tighten the hex screws since it may be necessary to move the left tube when installing the rest of the kit. (Fig. 4 / Fig. 5)

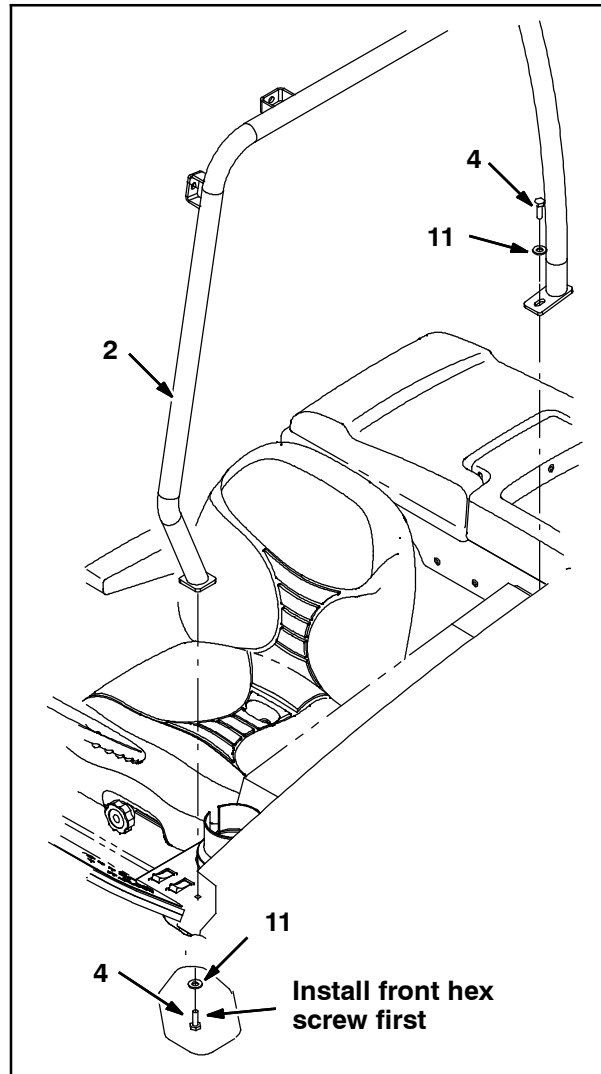

FIG. 4

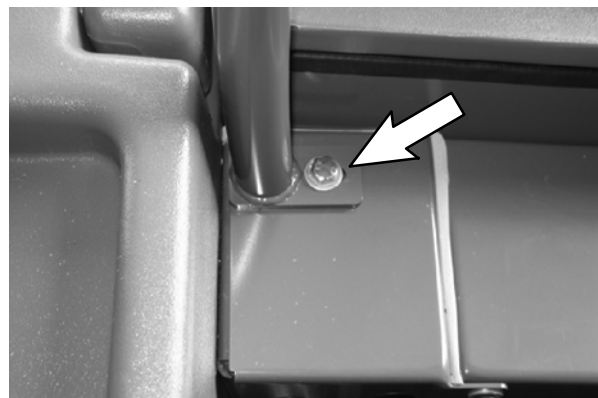

FIG. 5

6. Use two hex screws (4) and two flat washers (5) and (12) to install the right overhead guard tube (3) onto the machine. Do not completely tighten the hex screws since it may be necessary to move the right tube when installing the rest of the kit. (Fig. 6 / Fig. 7)

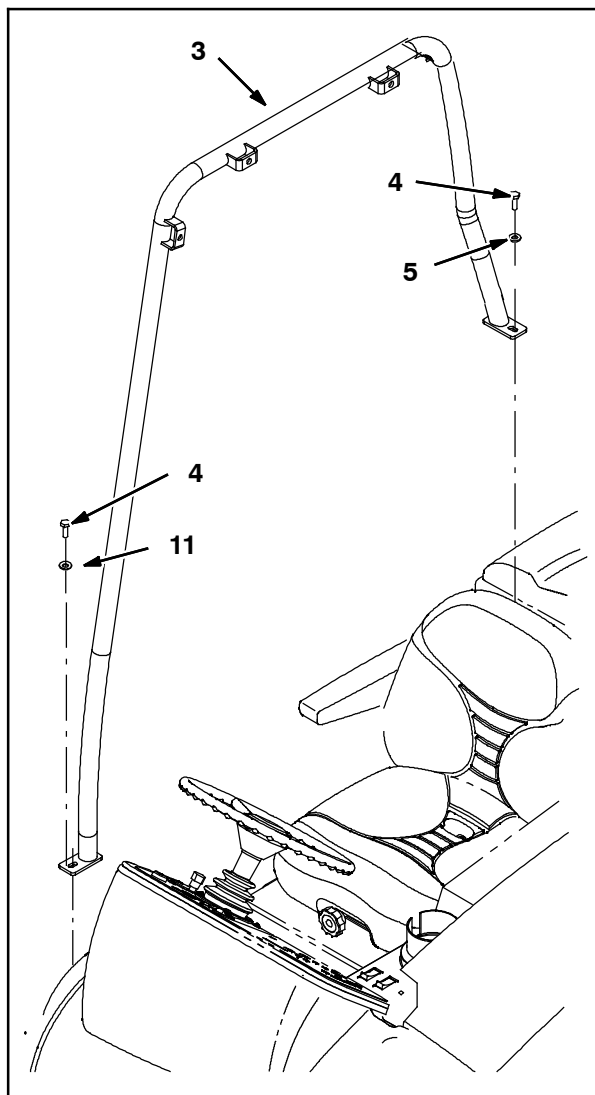

FIG. 6

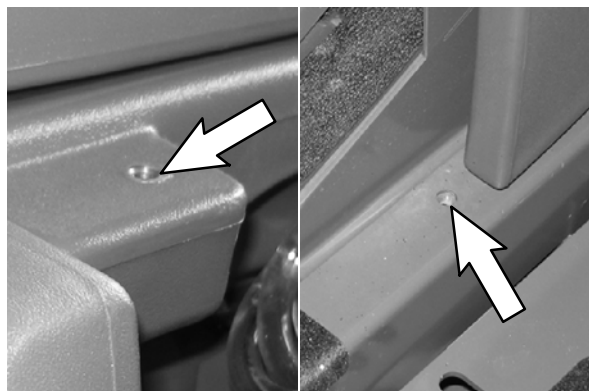

FIG. 7

7. Use seven hex screws (4), fourteen flat washers (5), and seven hex nuts (6) to install the overhead guard top onto the left overhead guard tube (2) and right overhead guard tube (3). Do not completely tighten the hex screws since it may be necessary to move the left overhead guard tube when installing the rest of the kit. (Fig. 8)
8. Use a hex nut (10) and flat washer (9) to the install the mirror (8) onto the mirror bracket (7). (Fig. 8)
9. Use a hex screw (4), two flat washers (5), and a hex nut (6) to install the mirror assembly onto the overhead guard assembly. (Fig. 8)
10. Tighten all loose hardware from the previous steps.
11. Reinstall the access panel into the operators compartment. (Fig. 1)

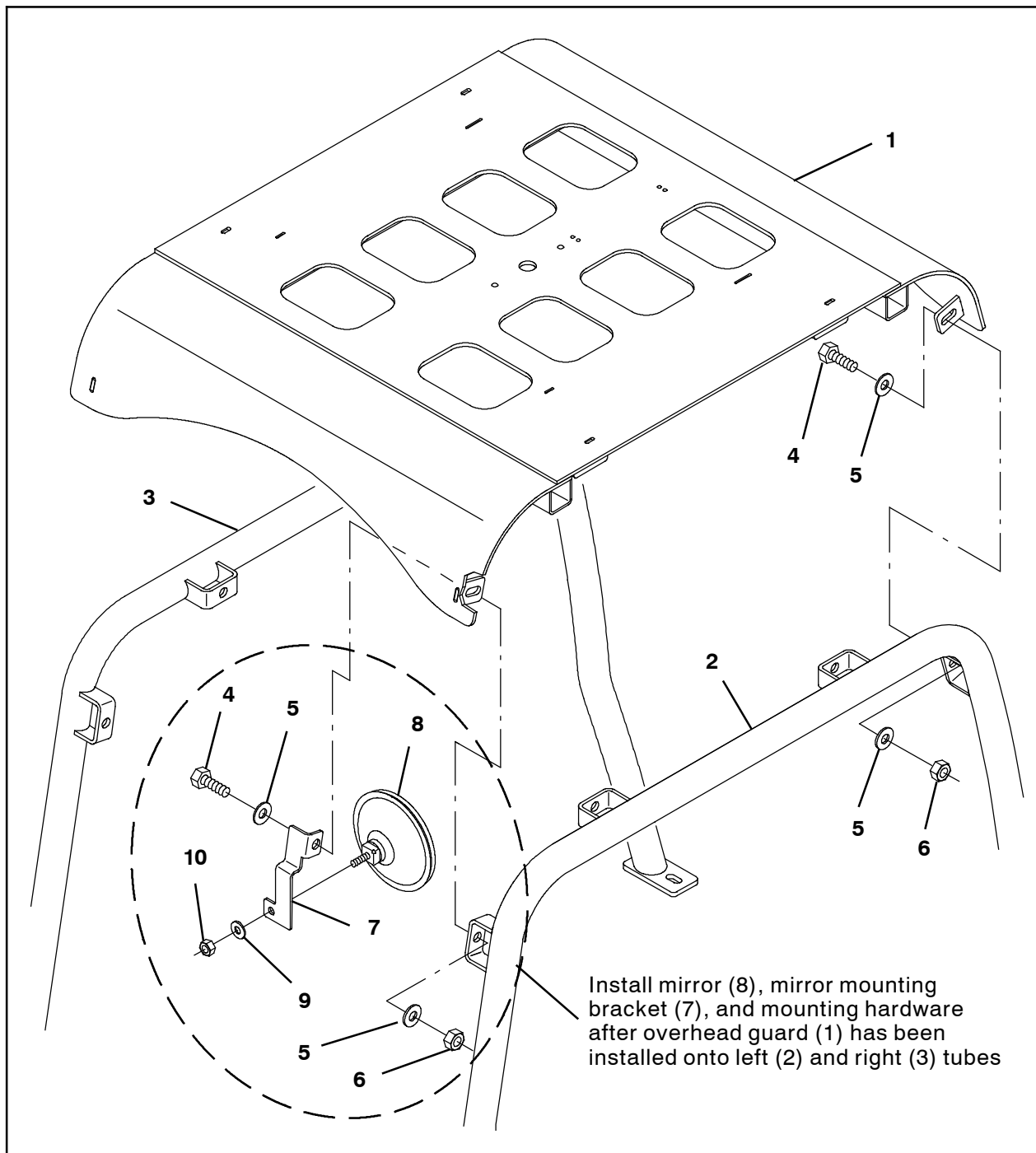

FIG. 8

Bill of Materials for OHG Kit, CI [M20 and T20]- 9001314

	Ref.	Tennant Part No.	Description	Qty.
▽		9001314	OHG Kit, Ci [M20 And T20]	1
▲	1	1022276	Guard Wldt, Top, OHG	1
▲	2	1022265	Tube Wldt, Leg, OHG, LH, Pntd	1
▲	3	1022266	Tube Wldt, Leg, OHG, RH, Pntd	1
▲	4	03192	Screw, Hex, M10 X 1.5 X 30, 8.8	12
▲	5	32492	Washer, Flat, 0.38 Std	17
▲	6	41430	Nut, Hex, Lock, M10 X 1.5, NI	8
▲	7	1023879	Bracket, Mtg, Mirror, Rearview	1
▲	8	369787	Mirror, Flat, 5.1d	1
▲	9	32491	Washer, Flat, 0.31, Std	1
▲	10	19313	Nut, Hex, Std, .31- 18	1
▲	11	1014563	Washer, Flat, 0.40B 1.12D .12,SS	3

TENNANT COMPANY
P. O. Box 1452
Minneapolis, MN 55440-1452